

• PARISH • OF • ECHT •
 • GLEBE • PLAN •

This is the Plan referred to in the foregoing Scheme, and signed as relative thereto.

Robert M. Blair Chairman

J. G. Fisher Secretary

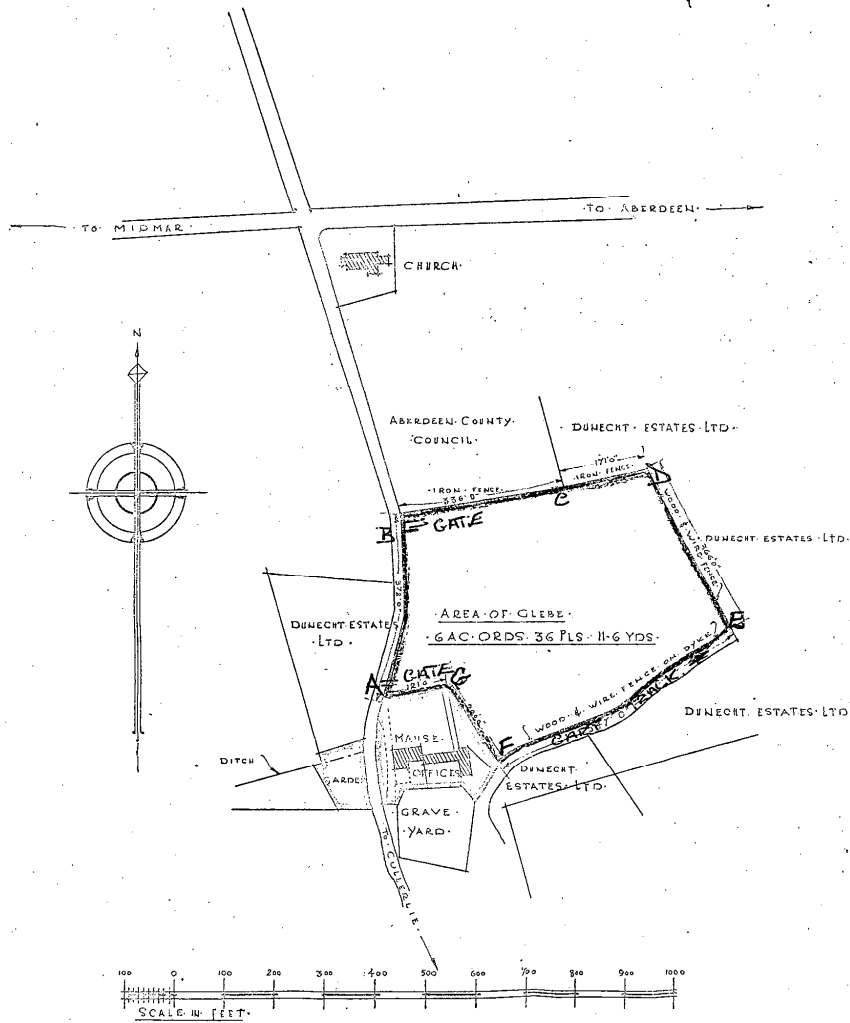

Aberdeenshire Local Development Plan 2008

Proposal for a site to be included in the Main Issues Report

Please use this form to provide details of the site that you would wish to have included in the Main Issues Report for consideration as a proposal for the Aberdeenshire Local Development Plan.

One of the purposes of this form is to inform a public debate on the merits of the different sites being proposed. All information submitted will therefore be made available to the public to promote a transparent and open process.

Please feel free to provide any further information you feel appropriate to support your submission. Please ensure your proposal is with us by 6 November 2008.

N1

Name of proposer: David A Phillips
Date:22/01/2009
Postal Address:Old Echt, Echt, Westhill, Aberdeenshire. AB32 7AJ

N2

Name of landowner (if known)
Postal address of landowner

To comply with the data protection Act1998 this information will not be made public

The site and your proposals

S1

Under what name would you like the site to be identified?The Glebe, Echt.

Have you any information on the internet which promotes your aspirations for the site? If so please provide the URL :

The site name could be descriptive ("Site north of") or an address (Site at Westburn Road , Aberdeen)

S2

Have you provided a map showing the exact boundaries of the site you would like considered?

S3

Yes No

Please provide the National Grid reference of the site

NJ 740/054

S4

What is the current use of the site? Let to a tenant for grazing

Has the land been built upon before (Brownfield Land)? Yes No

Is there any suspicion that the land is contaminated? Yes No

If yes Please provide a statement of the nature and extent of the contamination suspected
Statement attached

S5

What use(s) do you propose for your site? Development for housing

If you are proposing a mix of uses on your site please ensure that the area of each is noted on the site plan

S6

Are you proposing to phase your development? Yes No

If you are proposing phasing your development please provide additional details of what is anticipated to be built, and when.

S7

If you are proposing housing on the site please provide us with details of what you think would be appropriate, both in terms of the number of dwellings, and their form (Flats, detached houses etc). 25 Detached Houses

If you have a design statement or other details about what you would like to see on the site, please include it.

S8

If you are proposing business land please provide us with details of what you would market the land for?

Businesses and offices (Use class 4)

General industrial land (Use Class 5)

Storage and distribution (Use Class 6)

Do you have a specific occupier in mind for the site? Yes No

Please make sure the area of land proposed for business use shown on the site plan.

S9

If you are proposing uses other than housing or business please provide us with as much detail as possible on what you propose.

Please continue on additional sheets as required.

The wider area

A1

Please provide a statement on the siting and design of your proposal (how will the development fit in with the wider landscape, or complement the urban design of the area?) The glebe has defensible boundaries and compliments the form of the settlement and its landscape. The site is within the settlement boundary and is within 400m of the school, church, public hall and shop. The site is partially obscured from the B977 by hedging and mature trees. There are also mature trees on the north side adjacent to the council pleasure park. The old manse is screened from the proposed development by a high wall and mature trees. The proposed development would have very little visual impact on the existing settlement. Road safety through the settlement could be greatly improved by the provision of a roundabout at the access point to the proposed development from the B977 with the ensuing traffic calming effect.

If you have a landscape statement, a design statement or other details about what you would like to see on the site, please include it.

Statement attached

A2

If you have prepared any frameworks or masterplans showing a possible layout for the site, please include it with this form.

Framework attached

A3

Have you applied principles of sustainable siting and design to your site? Yes

No

If you have undertaken a site assessment please provide details

Statement attached

The Code for Sustainable homes or WWW.index21.org.uk provides guidance on this issue

Effect on the community

C1

Has there been any opportunity for local people to influence what you propose through local engagement?

Yes

No

Not Yet

If you have undertaken any community consultation please provide details of the ways in which engagement was conducted, its effectiveness and the way in which it has influenced your proposals. Please provide details of any engagement you may propose to undertake.

C2 At least 25% of all housing is likely to be required to be affordable. If applicable, are you considering providing more or less than this? More
25% or Less

C3 What community benefits arise from your proposals? What would the nature of these be, and how would they be delivered?

The new development would benefit the local school which is experiencing falling numbers. Ect parish church and Sunday school would also benefit from the increased populace as would the local shop and services. The public hall would benefit from the increased social activity. The Westhill industrial estate and business park is within a very short commuting distance and would allow local people to remain in the settlement. The affordable housing would allow young local people to get on to the property market in an otherwise expensive area.

Community benefits may be material, such as community facilities, or intangible, such as affordable housing or the ability to live locally. Include elements which you anticipate may be required as developer contributions from the development (although specifics will have to be negotiated with the Council on the basis of the development proposed)

C4 How easy is it for people using or living in the development you propose to access services? Are the following facilities within:

	400m	400m-1k	>1km
	<small>Please tick appropriate box</small>		
Local Shops	<input checked="" type="checkbox"/>	<input type="checkbox"/>	<input type="checkbox"/>
Community facilities (eg Hall)	<input checked="" type="checkbox"/>	<input type="checkbox"/>	<input type="checkbox"/>
Sports facilities (eg playing fields)	<input checked="" type="checkbox"/>	<input type="checkbox"/>	<input type="checkbox"/>
Employment areas	<input type="checkbox"/>	<input type="checkbox"/>	<input checked="" type="checkbox"/>
Residential areas	<input checked="" type="checkbox"/>	<input type="checkbox"/>	<input type="checkbox"/>
Public Transport networks	Yes <input checked="" type="checkbox"/>	No <input type="checkbox"/>	NA <input type="checkbox"/>
Other (Please specify)	Yes <input checked="" type="checkbox"/>	No <input type="checkbox"/>	NA <input type="checkbox"/>
Church, school and doctor's surgery			

If you propose to provide any of these as a component of the development itself then please answer "yes". NA=Not Applicable

Servicing the site

C5 Have you undertaken any of the following studies to determine whether your site is capable of being developed, or what might be required by you to make it developable?

Flood Risk Assessment	Yes	<input type="checkbox"/>	No	<input type="checkbox"/>	NA	<input checked="" type="checkbox"/>
Traffic Impact Assessment	Yes	<input type="checkbox"/>	No	<input checked="" type="checkbox"/>	NA	<input type="checkbox"/>
Drainage Impact Assessment	Yes	<input type="checkbox"/>	No	<input checked="" type="checkbox"/>	NA	<input type="checkbox"/>
Habitat / biodiversity Assessment	Yes	<input type="checkbox"/>	No	<input checked="" type="checkbox"/>	NA	<input type="checkbox"/>
Other as applicable (eg noise, dust, smell)						

Retail impact etc)

Yes No NA

Rather than full studies it may be appropriate to undertake initial assessments to identify the scale of any works that might be required, as this will impact on the deliverability of the proposal. This assessment may be no more than an exchange of letters with appropriate agencies. Information on water and sewage capacity is available online at :
http://www.scottishwater.co.uk/portal/page/portal/SWE_PGP_CONNECTIONS/SWE_CORP_CONNECTIONS/ASSET_CAPACITY_SEARCH

C6 What are the access arrangements you propose for the site. Does your site plan clearly show where you propose to access the road network? Yes No

Other information

O1 What other information would you like to be considered in support of your proposal? In order to comply with the Data Protection Act 1998 please do not include any personal information

The local community needs this development to bring back the vibrant heart which has been stifled by non development. In an area with such a strong demand for residential housing, there has been no significant development in the past 30 years.

Please return the completed form to the Policy Planning Team, Planning Policy and Environment Service , Woodhill House, Westburn Road, Aberdeen, AB16 5GB or e-mail to ldp@aberdeenshire.gov.uk.

Fair Processing Notice

- The Data Controller for this information is Aberdeenshire Council.
 - The data will be used for the following purposes:
 - 1) to inform a public debate on the merits of the different sites being proposed,
 - 2) to evaluate submitted bids
 - This data will potentially be disclosed worldwide (via publication on Internet)
- By completing and submitting this form, you are consenting to the above processing.