

Aberdeenshire Local Development Plan 2008

Proposal for a site to be included in the Main Issues Report

Please use this form to provide details of the site that you would wish to have included in the Main Issues Report for consideration as a proposal for the Aberdeenshire Local Development Plan.

One of the purposes of this form is to inform a public debate on the merits of the different sites being proposed. All information submitted will therefore be made available to the public to promote a transparent and open process.

Please feel free to provide any further information you feel appropriate to support your submission. Please ensure your proposal is with us by 6 November 2008.

N1

Name of proposer: Mr & Mrs DJ Egan

Date: 01 November 2008

Postal Address: Woodfield, Raemoir Road, BANCHORY, AB31 4ET

N2

Name of landowner (if known) [REDACTED]

Postal address of landowner [REDACTED]

To comply with the data protection Act 1998 this information will not be made public

The site and your proposals

S1

Under what name would you like the site to be identified? Woodfield Green. This is to reflect the fact that we would like the site to be as 'Green' as possible.

Have you any information on the internet which promotes your aspirations for the site? If so please provide the URL : No

The site name could be descriptive ("Site north of") or an address (Site at Westburn Road , Aberdeen)

S2

Have you provided a map showing the exact boundaries of the site you would like considered?

Yes No

S3

Please provide the National Grid reference of the site

NO 69610 97750

S4 What is the current use of the site? Private amenity land. Previously part of a small farm which ceased operations 20+ years ago.

I have answered Yes to the question immediately below as there were farm buildings on the site, most of which have been demolished. Please advise whether or not this answer is appropriate for any analysis of responses.

Has the land been built upon before (Brownfield Land)? Yes No

Is there any suspicion that the land is contaminated? Yes No

If yes Please provide a statement of the nature and extent of the contamination suspected
Statement attached

S5 What use(s) do you propose for your site? A small development of low cost houses with sustainable services such as geothermal 'district' heating, solar panels, rain water collection and grey water re-use.

Provision would be made for home grown produce either on each site or as a communal allotment.

If you are proposing a mix of uses on your site please ensure that the area of each is noted on the site plan

S6 Are you proposing to phase your development? Yes No

If you are proposing phasing your development please provide additional details of what is anticipated to be built, and when.

S7 If you are proposing housing on the site please provide us with details of what you think would be appropriate, both in terms of the number of dwellings, and their form (Flats, detached houses etc). The proposal is five sites which would either contain detached or semi-detached properties. Each property would be of 2 bedrooms in order to keep the cost down and make the properties affordable to local people.

If you have a design statement or other details about what you would like to see on the site, please include it.

S8 If you are proposing business land please provide us with details of what you would market the land for?

Businesses and offices (Use class 4)

General industrial land (Use Class 5)

Storage and distribution (Use Class 6)

Do you have a specific occupier in mind for the site? Yes No

Please make sure the area of land proposed for business use shown on the site plan.

S9 If you are proposing uses other than housing or business please provide us with as much detail as possible on what you propose. Not applicable

Please continue on additional sheets as required.

The wider area

A1 Please provide a statement on the siting and design of your proposal (how will the development fit in with the wider landscape, or complement the urban design of the area?)

We aspire to provide low lifetime cost housing for local people.

The plan is to provide services such as geothermal 'district' heating, solar panels, rainwater collection, grey water re-use and similar initiatives to minimise the lifetime impact of the development on the area.

We believe that this approach will complement the wider landscape.

If you have a landscape statement, a design statement or other details about what you would like to see on the site, please include it. *Statement attached*

A2

If you have prepared any frameworks or masterplans showing a possible layout for the site, please include it with this form. *Framework attached*

A3 Have you applied principles of sustainable siting and design to your site? Yes
No

If you have undertaken a site assessment please provide details

Statement attached

The Code for Sustainable homes or www.index21.org.uk provides guidance on this issue

Effect on the community

C1 Has there been any opportunity for local people to influence what you propose through local engagement? Yes
No
Not Yet

If you have undertaken any community consultation please provide details of the ways in which engagement was conducted, its effectiveness and the way in which it has influenced your proposals. Please provide details of any engagement you may propose to undertake.

C2 At least 25% of all housing is likely to be required to be affordable. If applicable, are you considering providing more or less than this? More
25% or Less

C3 What community benefits arise from your proposals? What would the nature of these be, and how would they be delivered?

The proposal is to provide low cost sustainable housing in a semi-rural environment for people who would like to live and work locally.

Provision will be made for growing produce.

The community will benefit from a low carbon footprint arising from the planned geothermal heating and other suggestions included in this proposal.

A further benefit to the local community is avoiding more high density housing.

Community benefits may be material, such as community facilities, or intangible, such as affordable housing or the ability to live locally. Include elements which you anticipate may be required as developer contributions from the development (although specifics will have to be negotiated with the Council on the basis of the development proposed)

C4 How easy is it for people using or living in the development you propose to access services? Are the following facilities within:

	400m	400m-1k	>1km
Local Shops	<input type="checkbox"/>	<input checked="" type="checkbox"/>	<input type="checkbox"/>
Community facilities (eg Hall)	<input type="checkbox"/>	<input checked="" type="checkbox"/>	<input type="checkbox"/>
Sports facilities (eg playing fields)	<input type="checkbox"/>	<input checked="" type="checkbox"/>	<input type="checkbox"/>
Employment areas	<input type="checkbox"/>	<input checked="" type="checkbox"/>	<input type="checkbox"/>
Residential areas	<input checked="" type="checkbox"/>	<input type="checkbox"/>	<input type="checkbox"/>
Public Transport networks	Yes <input checked="" type="checkbox"/>	No <input type="checkbox"/>	NA <input type="checkbox"/>
Other (Please specify)	Yes <input type="checkbox"/>	No <input type="checkbox"/>	NA <input type="checkbox"/>

Please tick appropriate box

If you propose to provide any of these as a component of the development itself then please answer "yes". NA=Not Applicable

Servicing the site

C5 Have you undertaken any of the following studies to determine whether your site is capable of being developed, or what might be required by you to make it developable?

Flood Risk Assessment Yes No NA

Traffic Impact Assessment	Yes	<input type="checkbox"/>	No	<input checked="" type="checkbox"/>	NA	<input type="checkbox"/>
Drainage Impact Assessment	Yes	<input type="checkbox"/>	No	<input checked="" type="checkbox"/>	NA	<input type="checkbox"/>
Habitat / biodiversity Assessment	Yes	<input type="checkbox"/>	No	<input checked="" type="checkbox"/>	NA	<input type="checkbox"/>
Other as applicable (eg noise, dust, smell Retail impact etc)	Yes	<input type="checkbox"/>	No	<input checked="" type="checkbox"/>	NA	<input type="checkbox"/>

Rather than full studies it may be appropriate to undertake initial assessments to identify the scale of any works that might be required, as this will impact on the deliverability of the proposal. This assessment may be no more than an exchange of letters with appropriate agencies. Information on water and sewage capacity is available online at :
http://www.scottishwater.co.uk/portal/page/portal/SWE_PGP_CONNECTIONS/SWE_CORP_CONNECTIONS/ASSET_CAPACITY_SE
ARCH

C6 What are the access arrangements you propose for the site. Does your site plan clearly show where you propose to access the road network? Yes No

Other information

O1 What other information would you like to be considered in support of your proposal? In order to comply with the Data Protection Act 1998 please do not include any personal information

Given that Banchory may expand to the north, we would just like to see a small part of that development dedicated to low cost sustainable housing for people who work locally.

David Egan

05 November 2008

Please return the completed form to the Policy Planning Team, Planning Policy and Environment Service , Woodhill House, Westburn Road, Aberdeen, AB16 5GB or e-mail to ldp@aberdeenshire.gov.uk.

Fair Processing Notice

- The Data Controller for this information is Aberdeenshire Council.
 - The data will be used for the following purposes:
 - 1) to inform a public debate on the merits of the different sites being proposed,
 - 2) to evaluate submitted bids
 - This data will potentially be disclosed worldwide (via publication on Internet)
- By completing and submitting this form, you are consenting to the above processing.

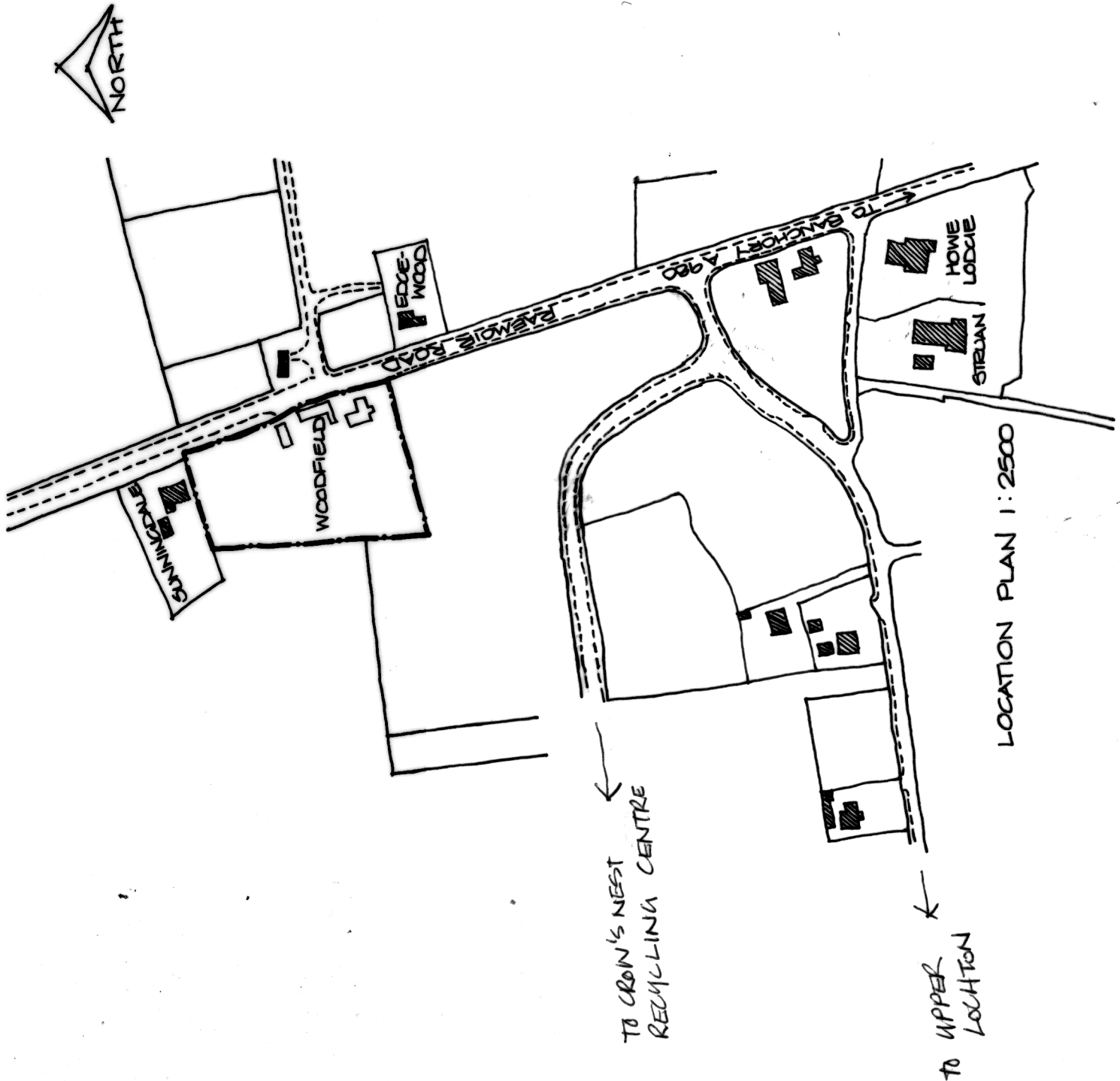

George Watt & Stewart
 Chartered Architects and Planning Consultants

24 North Silver Street
 Aberdeen AB10 1RL
 Tel. 01224 639232
 Fax. 01224 630164

Sheet Title
**WOODFIELD
 RAEMOIR RD
 BANCHOET**

Scales 1:2500
 Drawing Number

55516 / PO1

Date **SEPT 08**
 Drawn **JMT**

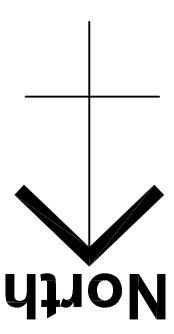

5 New Sites
nom. 0.2 Acres each

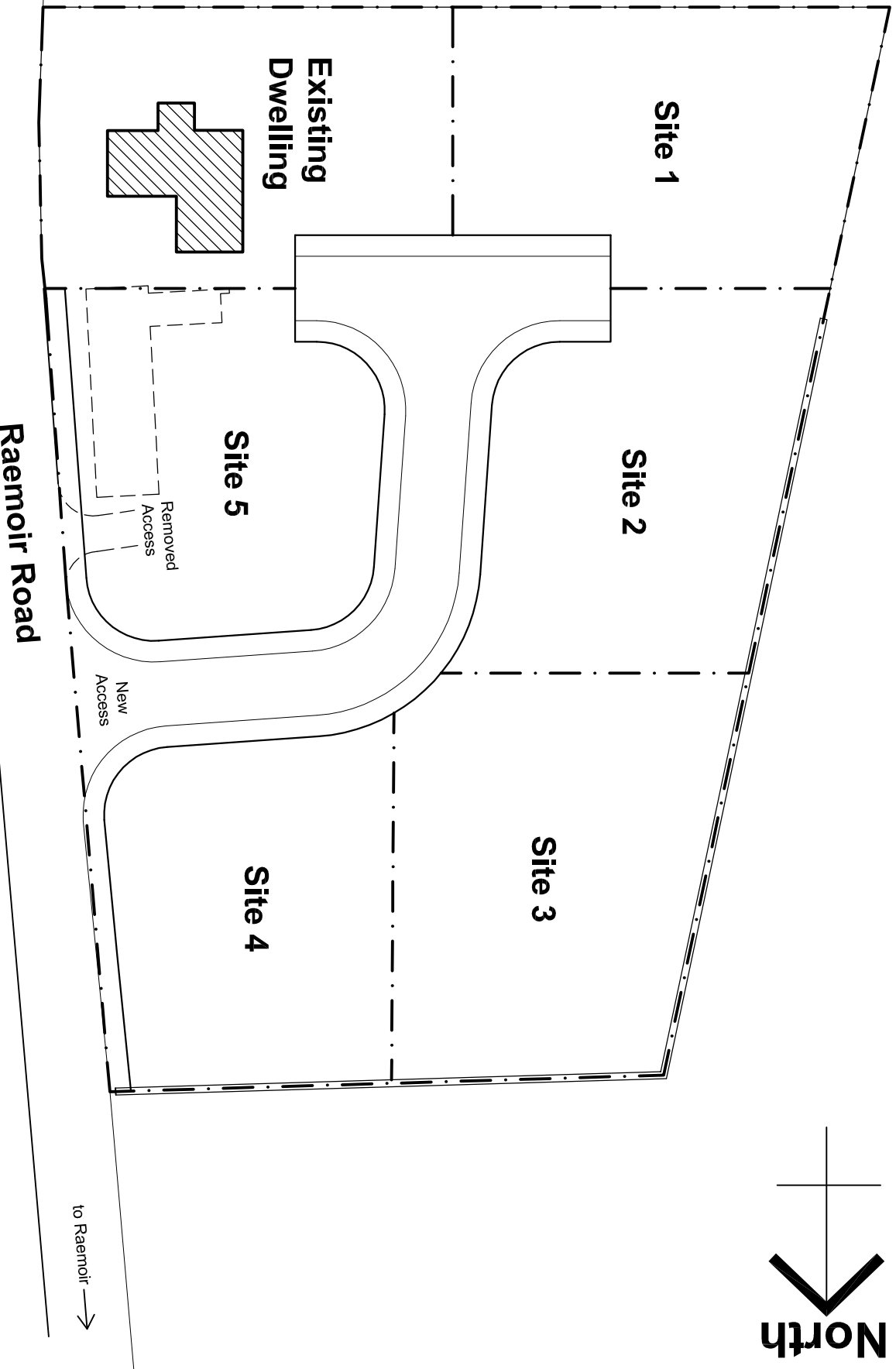

REV	DESCRIPTION	DATE	BY	PROJECT Potential Site Development Woodfield Raemoir Road, Banchory Mr. & Mrs. Egan	
TITLE Potential Site Plan		SCALE 1:500 @ A4 DATE 10 08		DWG. NO. 5556/SK100	
				George Watt & Stewart Chartered Architects and Planning Consultants 24 North Silver Street Aberdeen, AB10 1RL 01224 639232 Tel 01224 630164 Fax mail@gws-architects.co.uk E-mail	