

Aberdeenshire Local Development Plan 2008

Proposal for a site to be included in the Main Issues Report

Please use this form to provide details of the site that you would wish to have included in the Main Issues Report for consideration as a proposal for the Aberdeenshire Local Development Plan.

One of the purposes of this form is to inform a public debate on the merits of the different sites being proposed. All information submitted will therefore be made available to the public to promote a transparent and open process.

Please feel free to provide any further information you feel appropriate to support your submission. Please ensure your proposal is with us by 6 November 2008.

N1

Name of proposer: Norman P Lawie Ltd

Date: 03 November 2008

Postal Address:

Architectural Design,
Tumulus Way,
Midmill Business Park,
Kintore,
Aberdeenshire, AB51 0TG
(Tel: 01467 633064 / Fax: 01467 633207)

e-mail: norman@lawie.co.uk

N2

Name of landowner (if known) [REDACTED]

Postal address of landowner [REDACTED]

To comply with the data protection Act 1998 this information will not be made public

The site and your proposals

S1

Under what name would you like the site to be identified? Site North East of Montgarrie

Have you any information on the internet which promotes your aspirations for the site? If so please provide the URL :

M56

The site name could be descriptive ("Site north of") or an address (Site at Westburn Road , Aberdeen)

S2 Have you provided a map showing the exact boundaries of the site you would like considered?

S3 Yes No

Please provide the National Grid reference of the site

NJ 576179

S4 What is the current use of the site? Arable land

Has the land been built upon before (Brownfield Land)? Yes No

Is there any suspicion that the land is contaminated? Yes No

If yes Please provide a statement of the nature and extent of the contamination suspected
Statement attached

S5 What use(s) do you propose for your site? see attached statement

If you are proposing a mix of uses on your site please ensure that the area of each is noted on the site plan

S6 Are you proposing to phase your development? Yes No

If you are proposing phasing your development please provide additional details of what is anticipated to be built, and when.

See attached statement

S7 If you are proposing housing on the site please provide us with details of what you think would be appropriate, both in terms of the number of dwellings, and their form (Flats, detached houses etc).

See attached statement

If you have a design statement or other details about what you would like to see on the site, please include it.

S8

M56

If you are proposing business land please provide us with details of what you would market the land for?

Businesses and offices (Use class 4)

General industrial land (Use Class 5)

Storage and distribution (Use Class 6)

Do you have a specific occupier in mind for the site? Yes No

Please make sure the area of land proposed for business use shown on the site plan.

S9

If you are proposing uses other than housing or business please provide us with as much detail as possible on what you propose. Site for commercial/retail or community use and landscaping/open space

Please continue on additional sheets as required.

The wider area

A1

Please provide a statement on the siting and design of your proposal (how will the development fit in with the wider landscape, or complement the urban design of the area?)

See attached statement

If you have a landscape statement, a design statement or other details about what you would like to see on the site, please include it. *Statement attached*

A2

If you have prepared any frameworks or masterplans showing a possible layout for the site, please include it with this form. *Framework attached*

A3

Have you applied principles of sustainable siting and design to your site? Yes
No

If you have undertaken a site assessment please provide details

M56

Statement attached



The Code for Sustainable homes or www.index21.org.uk provides guidance on this issue

Effect on the community

Q1

Has there been any opportunity for local people to influence what you propose through local engagement?

Yes

No

Not Yet

If you have undertaken any community consultation please provide details of the ways in which engagement was conducted, its effectiveness and the way in which it has influenced your proposals. Please provide details of any engagement you may propose to undertake.

M56

C2 At least 25% of all housing is likely to be required to be affordable. If applicable, are you considering providing more or less than this? More
25% or Less

C3 What community benefits arise from your proposals? What would the nature of these be, and how would they be delivered?

See statement attached

Community benefits may be material, such as community facilities, or intangible, such as affordable housing or the ability to live locally. Include elements which you anticipate may be required as developer contributions from the development (although specifics will have to be negotiated with the Council on the basis of the development proposed)

C4 How easy is it for people using or living in the development you propose to access services? Are the following facilities within:

	400m	400m-1k	>1km
	<small>Please tick appropriate box</small>		
Local Shops	<input type="checkbox"/>	<input type="checkbox"/>	<input checked="" type="checkbox"/>
Community facilities (eg Hall)	<input type="checkbox"/>	<input type="checkbox"/>	<input checked="" type="checkbox"/>
Sports facilities (eg playing fields)	<input type="checkbox"/>	<input type="checkbox"/>	<input checked="" type="checkbox"/>
Employment areas	<input checked="" type="checkbox"/>	<input type="checkbox"/>	<input type="checkbox"/>
Residential areas	<input checked="" type="checkbox"/>	<input type="checkbox"/>	<input type="checkbox"/>
Public Transport networks	Yes <input type="checkbox"/>	No <input type="checkbox"/>	NA <input type="checkbox"/>
Other (Please specify)	Yes <input type="checkbox"/>	No <input type="checkbox"/>	NA <input type="checkbox"/>

If you propose to provide any of these as a component of the development itself then please answer "yes". NA=Not Applicable

Servicing the site

C5 Have you undertaken any of the following studies to determine whether your site is capable of being developed, or what might be required by you to make it developable?

Flood Risk Assessment	Yes <input type="checkbox"/>	No <input checked="" type="checkbox"/>	NA <input type="checkbox"/>
Traffic Impact Assessment	Yes <input type="checkbox"/>	No <input checked="" type="checkbox"/>	NA <input type="checkbox"/>
Drainage Impact Assessment	Yes <input type="checkbox"/>	No <input checked="" type="checkbox"/>	NA <input type="checkbox"/>
Habitat / biodiversity Assessment	Yes <input type="checkbox"/>	No <input checked="" type="checkbox"/>	NA <input type="checkbox"/>
Other as applicable (eg noise, dust, smell Retail impact etc)	Yes <input type="checkbox"/>	No <input checked="" type="checkbox"/>	NA <input type="checkbox"/>

Rather than full studies it may be appropriate to undertake initial assessments to identify the scale of any works that might be required, as this will impact on the deliverability of the proposal. This assessment may be no more than an exchange of letters with appropriate agencies. Information on water and sewage capacity is available online at :

M56

http://www.scottishwater.co.uk/portal/page/portal/SWE_PGP_CONNECTIONS/SWE_CORP_CONNECTIONS/ASSET_CAPACITY_SE
ARCH

- Q6 What are the access arrangements you propose for the site. Does your site plan clearly show where you propose to access the road network? Yes No

Other information

- Q1 What other information would you like to be considered in support of your proposal? In order to comply with the Data Protection Act 1998 please do not include any personal information

See attached statement

Please return the completed form to the Policy Planning Team, Planning Policy and Environment Service , Woodhill House, Westburn Road, Aberdeen, AB16 5GB or e-mail to ldp@aberdeenshire.gov.uk.

Fair Processing Notice

- The Data Controller for this information is Aberdeenshire Council.
- The data will be used for the following purposes:

M56

- 1) to inform a public debate on the merits of the different sites being proposed,
 - 2) to evaluate submitted bids
- This data will potentially be disclosed worldwide (via publication on Internet)
- By completing and submitting this form, you are consenting to the above processing.

MS6

**ABERDEENSHIRE LOCAL DEVELOPMENT PLAN 2008
PROPOSAL FOR A SITE TO BE INCLUDED IN THE MAIN ISSUES REPORT**

**PROPOSAL:
SITE NORTH EAST OF MONTGARRIE**

ORDNANCE SURVEY GRID REFERENCE: NJ576179

DEVELOPMENT STATEMENT

SITE AND PROPOSAL

The Aberdeenshire Local Plan indicates that the settlement of Montgarrie shows an area fh1* outwith the settlement boundary. This area is the basis of this proposal.

The proposal allows for a home zone of housing on the South sloping area at the rear of the existing housing along the Keig road. This residential area would be suitable for around 20 to 25 units. As the existing settlement is near Alford there are very few commercial premises in the settlement. The proposal as indicated includes an area at the entrance to the development which could be retained for commercial, retail or community use, this area extends to 0.21 ha.

The access for this proposal would be taken off the Keig road at a position providing suitable visibility.

As the total site area is 2.44 h.a and the proposed development area is around 0.91 ha for residential use, this allows a large area for landscaping and public open space, together with provision for footpaths.

The development would be phased; this will depend on the approved Development Plan and the market demand at the time of a planning application.

Although reference is made on the application form to "Index 21" it is noted that the "tool" to assess specific sites is not yet available and at this stage of the Development Plan process the house layout will depend greatly on the outcome of the bid process.

We anticipate that the layout will be designed in such a way as to provide a high percentage when designed and entered into the result section of Index 21.

Regarding the house design, we understand that all new houses should meet the highest achievable standards but at the stage of site bids we believe that the house design section of Index 21 is not relevant.

M 56

SUSTAINABLE DEVELOPMENT

PURPOSE

The development should be located to reduce effect on the environment.

The development should allow for reductions in demand for energy during construction and in particular after completion.

The development should reduce the demand for resources of services. E.g. water, waste etc.

The development should provide a sustainable living and working environment.

PROPOSAL

Generally, all the above purposes relating to sustainable development have or will be taken into account in relation to this proposal.

In particular the development is on an area of South sloping ground and would integrate well with the existing settlement, being the search area for housing in the existing Local Plan.

The provision of commercial, retail or community facilities on part of the proposed site would allow for a sustainable living and working environment.

M56

ENVIRONMENT

PURPOSE

The development should retain and protect natural and built environment.

The development should provide sensitive quality development.

The development should provide a 'sense of space'.

PROPOSAL

The proposal has taken into account the natural environment, and with the landscaping and open space elements together with the potential uses other than housing, this proposal will provide a 'sense of space'.

M56

COMMUNITY

PURPOSE

The development should provide a sustainable community.

The development should provide a mix of house sizes and types including affordable housing.

The development should provide community areas within the housing proposals.

The development should allow for the reduced use of the car and increased use of walking, cycling and public transport.

The development should allow for required infrastructure for the proposal and the existing settlement.

PROPOSAL

The proposal relating to the residential development will be detailed to provide the required house mix including the necessary affordable housing element.

The proposal for the commercial or other use development will allow the possibility of reduced car use by providing housing and workplaces within the settlement.

The proposals for the increase of open public space around the development site and the provision of the uses other than housing would allow for the infrastructure requirements relating to the existing and extended community.

MSG

SITE SERVICING

PURPOSE

The development should be provided with adequate sewage, drainage and access and distribution provisions.

PROPOSAL

The proposal may require the upgrading of the existing foul sewage and the surface water to be disposed off by on site treatment, the costs of which would be borne by the developers.

The proposal would provide good access to the existing road network, all in accordance with the Transportation and Roads department requirements, providing adequate interconnection with the existing settlement both vehicular and pedestrian.

GENERAL

As the bid process is one of the first stages of our involvement in the Development Plan process and is an ongoing process, we request that we are informed of any proposed decisions or recommendations that the Council intend to make.

The Council may take differing views to us of our bids and we reserve the right to further justify or amend our bids in light of further information received during the processing of the Development Plan.

Montgarrie

Reproduced from the Ordnance Survey plan within the Aberdeenshire Local Plan with the permission of the controller of Her Majesty's stationery office, crown copyright reserved. Norman P. Lawie Ltd., Architectural Design, Tumulus Way, Kintore, Aberdeenshire, AB51 0TG Licence Number AR185027

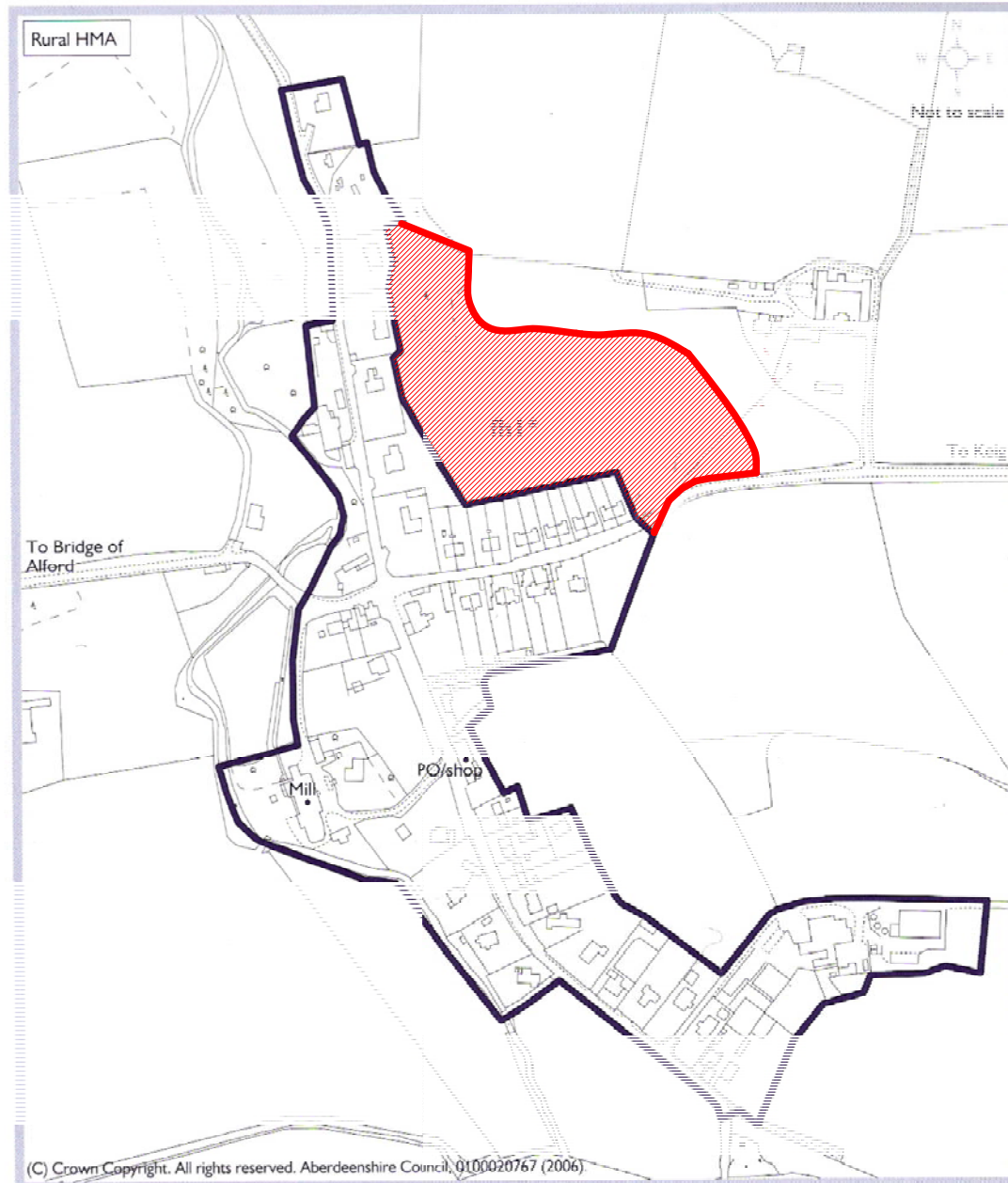

Red line and red hatching indicates proposed extension to settlement boundary

**PROPOSED LAND BID
AT MONTGARRIE,
ABERDEENSHIRE.**

Norman P. Lawie Ltd
Architectural Design

www.lawie.co.uk

Tumulus Way, Midmill Business Park,
Kintore, Aberdeenshire, AB51 0TG

Tel. (01467) 633064 Fax. (01467) 633207
e-mail : norman@lawie.co.uk

All sizes to be checked on site prior to construction
This plan may not be reproduced without the prior
consent of Norman P. Lawie Ltd.

Certified True Copy

This is the plan referred to in the
foregoing application

Scale :- Not To Scale

Date :- October 2008

Ref. No. :- C/956/14/2

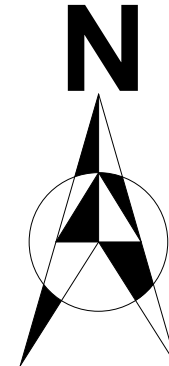
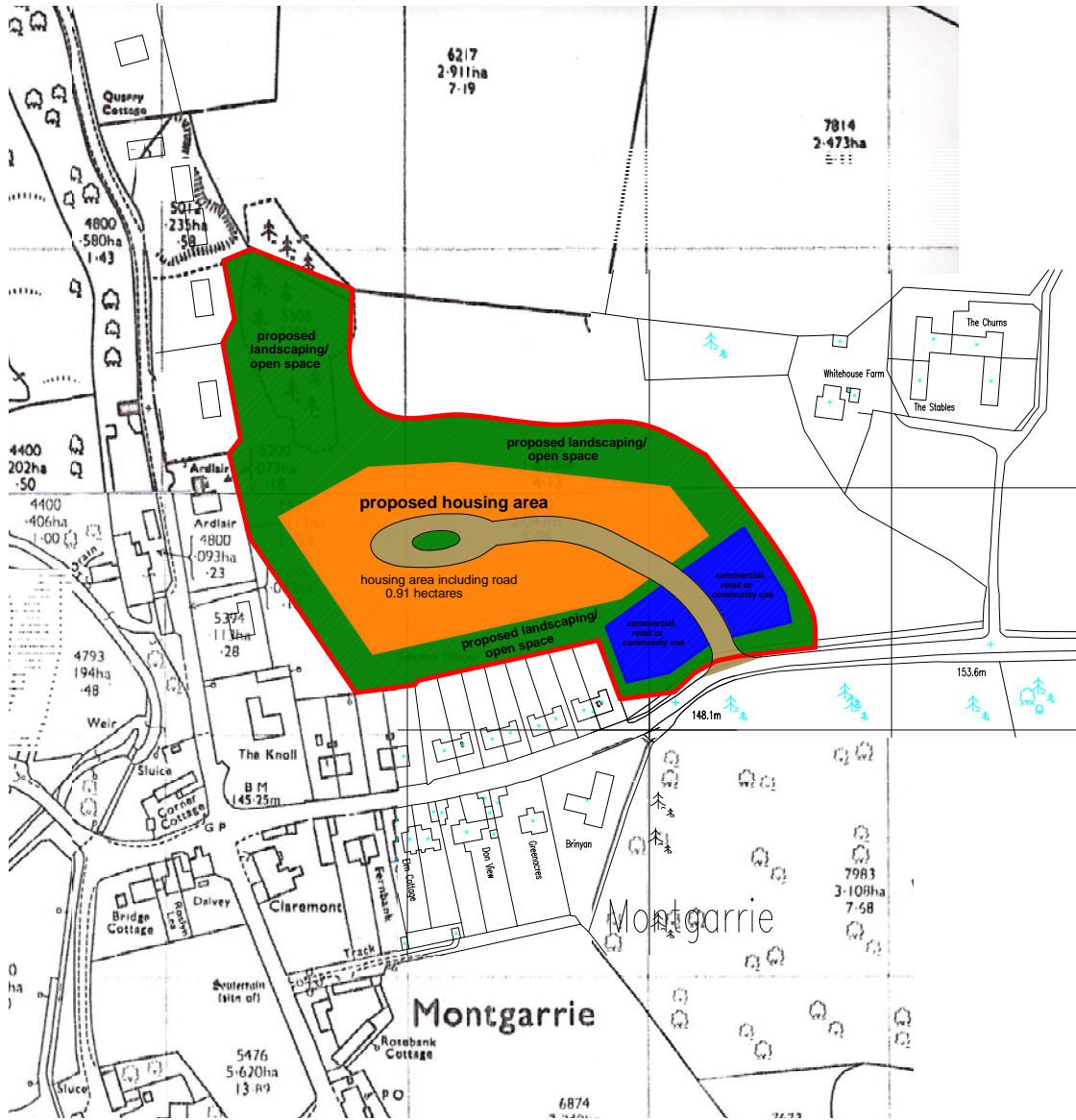

Reproduced from the 2008 & 1976 Ordnance Survey 1:2500 map (scaled to 1:1000) with the permission of the controller of Her Majesty's stationery office, crown copyright reserved. Norman P. Lawie Ltd., Architectural Design, Tumulus Way, Kintore, Aberdeenshire, AB51 0TG Licence Number AR185027

<p>PROPOSED LAND BID AT MONTGARRIE, ABERDEENSHIRE.</p>
<p>Norman P. Lawie Ltd Architectural Design www.lawie.co.uk Tumulus Way, Midmill Business Park, Kintore, Aberdeenshire, AB51 0TG Tel: (01487) 633064 Fax: (01487) 633207 e-mail: norman@lawie.co.uk</p>
<p>All sizes to be checked on site prior to construction This plan may not be reproduced without the prior consent of Norman P. Lawie Ltd.</p>
<p>Certified True Copy This is the plan referred to in the foregoing application</p>
<p>Scale :- 1-1000</p>
<p>Date :- October 2008</p>
<p>Ref. No. :- C/956/14/1</p>