



BANCHORY - PROPOSED ZEBRA CROSSING

Aberdeenshire Council proposes to introduce a zebra crossing in Banchory under Chapter 27, Section 23 of the Road Traffic Regulation Act, 1984.

Zebra Crossing Location - Arbeadie Road, Banchory from a point 6 metres north of the extended east kerb line of Ramsay Road to a point 52 metres north of the extended east kerbline of Ramsay Road.

Details of the proposal, location plan and a statement of the Council's reasons for proposing to introduce the crossing, may be examined online via www.aberdeenshire.gov.uk/roads-and-travel/roads/traffic-management/traffic-measures/ Any queries should be directed to Fiona McLaren on 01467 537572.

The proposal will be on display from 15 August 2025 until 29 August 2025.

Head of Legal and People,
Woodhill House, Westburn Road, Aberdeen, AB16 5GB

ABERDEENSHIRE COUNCIL

STATEMENT OF REASONS

BANCHORY - PROPOSED ZEBRA CROSSING

Aberdeenshire Council is satisfied that the implementation of the proposed Zebra crossing will provide a safer means of crossing Arbeadie Road, Banchory. The crossing has been assessed in line with the Pedestrian Crossing Assessment Policy where it met the criteria for the introduction of a zebra crossing.

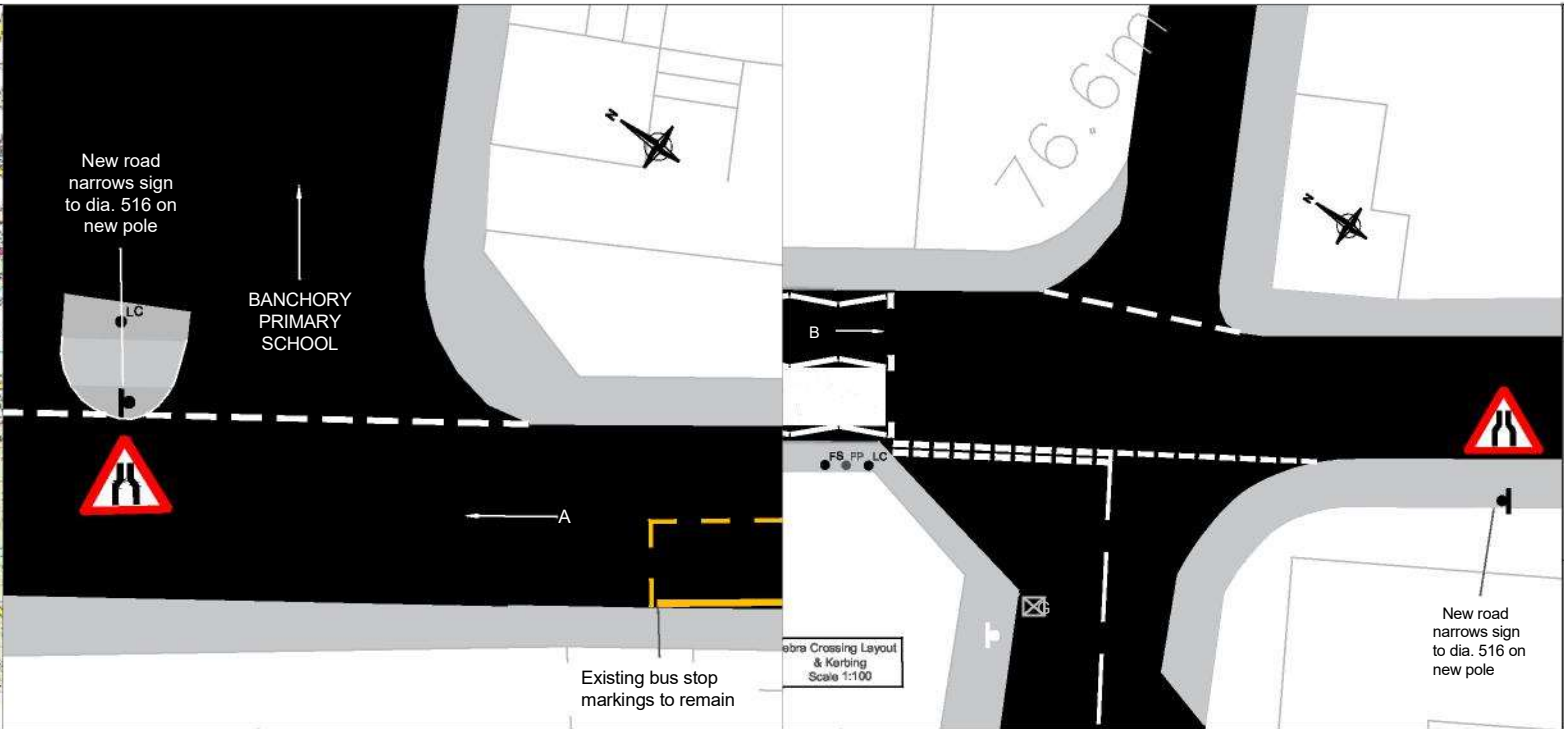
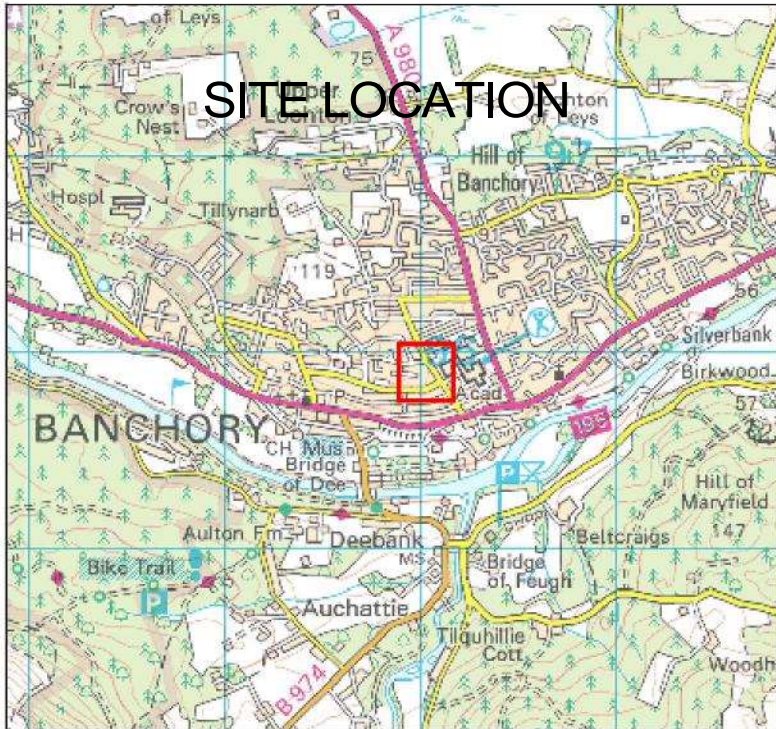

KEY				
	G	Existing Road Gully		
		Precast Half Battered Kerb		
		Precast Bullnose Dropped Kerb		
		Precast Double Dropper Kerbs		
		Precast Flat Top Edge Kerbs		
		New Red Coloured Tactiles		
		New Footway		
		New Buildout		
	LC	Existing Street Lighting Column		
	FP	Existing Feeder Pillar Existing		
	FS	Flashing 20mph Sign		

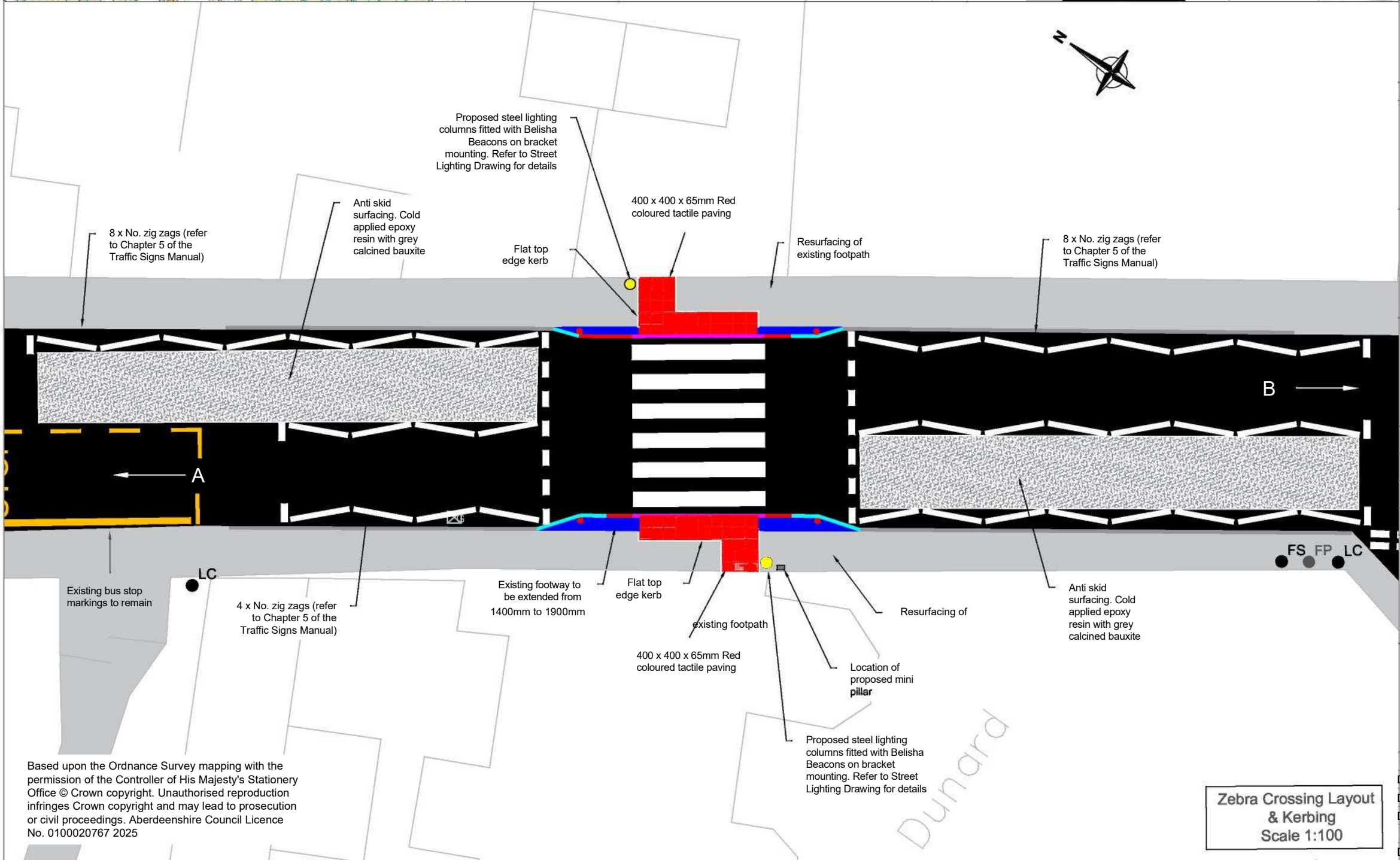

Rev	Amendment Description	By	Chkd	Date
A	Taper transition at buildouts extended, tactiles and zebra lining extended	FMc	SC	02/07/25

Client/Architect Name & Address

Aberdeenshire Council
Roads & Infrastructure

Aberdeenshire Council Environment & Infrastructure

PROJECTS

HEAD OF ROADS AND INFRASTRUCTURE
VIEWMOUNT
ARDUTHIE ROAD
STONEHAVEN
AB39 2DQ

Drawing Scale	1:1250 @ A3 Size
This drawing to be read in conjunction with the following:	
Drawing Nos.	
Schedule Nos.	

Project Title/Address

Proposed Zebra Crossing
Arbedie Road, Banchory

Drawing Title

General Arrangement

Designed by	FMcL	Issue Status	Projection
Date	22/04/25	DRAFT	
Drawn by	FMcL		
Date	22/04/25	Contract Drawing No.	Revision No.
Checked by	SC	765104-D-DG-0000-01 GA	A
Date	19/05/25		

Based upon the Ordnance Survey mapping with the permission of the Controller of His Majesty's Stationery Office © Crown copyright. Unauthorised reproduction infringes Crown copyright and may lead to prosecution or civil proceedings. Aberdeenshire Council Licence No. 0100020767 2025

Zebra Crossing Layout
& Kerbing
Scale 1:100